

# WELCOME

**Society of American Military Engineers  
Omaha Post and  
Engineers Roundtable  
February 22nd - Engineers' Week Banquet**

# Sponsor Spotlights

**Thank you to our GOLD Sponsor!**

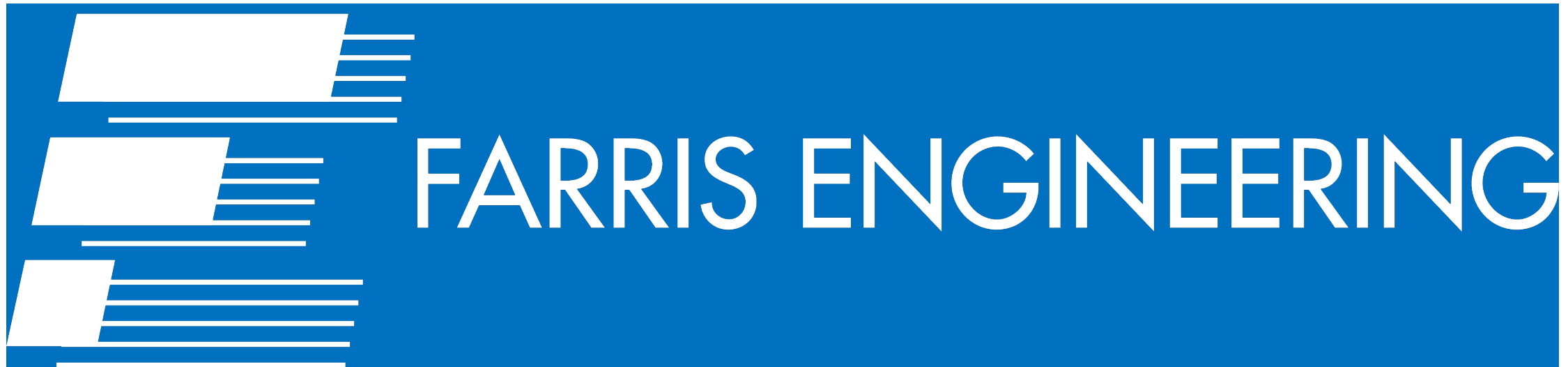

# Sponsor Spotlights

**Thank you to our SILVER Sponsors!**



# Banquet Agenda

- Pledge of Allegiance
- Announcements
- Invocation
- Dinner
- Presentation
- Q&A
- Split Kitty Drawing
- Closing Remarks

# Pledge of Allegiance



I pledge allegiance to the Flag of the United States of America, and to the Republic for which it stands, one Nation under God, indivisible, with liberty and justice for all.

# Announcements

- **March Membership Meeting**
  - ▶ March 12<sup>th</sup> @ Field Club of Omaha
  - ▶ 11:00 AM-1:00 PM
  - ▶ Topic: USAFA Chapel Restoration Project Spotlight

# Announcements

- **Omaha Industry Days**
  - ▶ May 29<sup>th</sup>-May 31st, 2024 at CHI Center

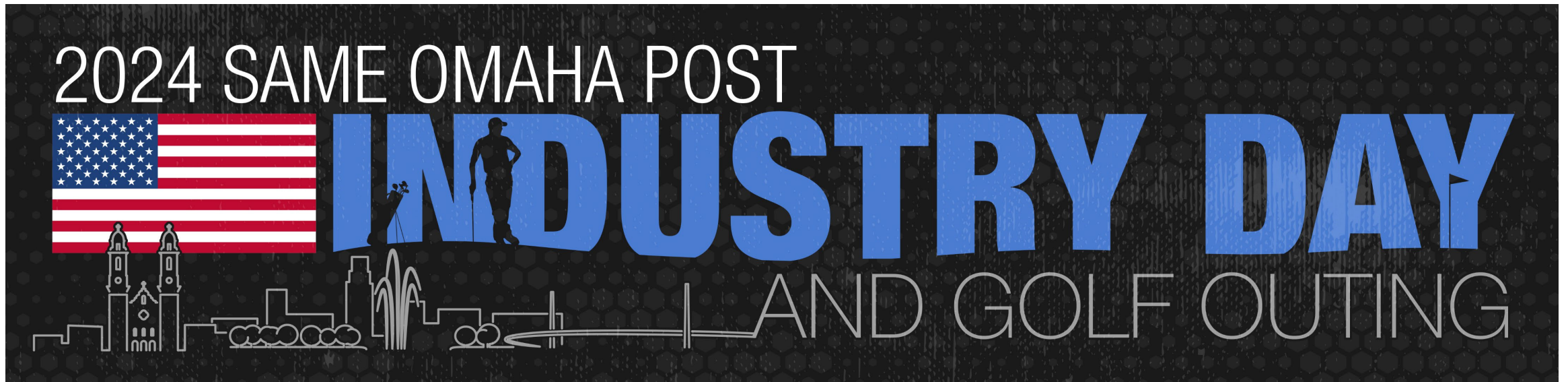



# Invocation

Please join us in the invocation before we dismiss for dinner



# Dinner

Dismiss by table

# **Eppley Airfield Terminal Modernization Program**

**Daniel B. Owens, P.E**  
**Director of Planning & Engineering**  
**Omaha Airport Authority**

**BUILD** **OMA**



# The Eppley Airfield Terminal Modernization Program

February 22, 2024

# Agenda

1. About the Omaha Airport Authority
2. Passenger Activity & Air Service
3. Terminal Modernization Program Update

# About the Omaha Airport Authority

# Omaha Airport Authority

- Created via state statute in 1959 through the Cities Airport Authorities Act
- Political Subdivision and Municipal Corporation
- Governed by a five-member Board of Directors
- Operate both Eppley Airfield and Millard Airport
- Non-taxing authority, user fee airports

# Passenger Activity & Air Service

# Eppley Airfield is the 62<sup>nd</sup> Largest Airport in the US by Enplanements

2022				
<u>Rank</u>	<u>ID</u>	<u>City</u>	<u>Hub Size</u>	<u>Enplanements</u>
52	PBI	West Palm Beach	Medium	3,257,730
53	JAX	Jacksonville	Medium	3,177,393
54	BUR	Burbank	Medium	3,054,729
55	BDL	Hartford	Medium	2,844,713
56	ONT	Ontario	Medium	2,840,758
57	MKE	Milwaukee	Medium	2,671,281
58	CHS	Charleston	Medium	2,608,497
59	ANC	Anchorage	Medium	2,604,308
60	ABQ	Albuquerque	Medium	2,317,836
61	BOI	Boise	Medium	2,230,467
<b>62</b>	<b>OMA</b>	<b>Omaha</b>	<b>Medium</b>	<b>2,204,395</b>
63	MEM	Memphis	Medium	2,163,692
64	RNO	Reno	Medium	2,132,856
65	ORF	Norfolk	Small	2,065,116
66	RIC	Richmond	Small	2,042,834
67	BUF	Buffalo	Small	2,007,508
68	KOA	Kailua Kona	Small	2,006,013
69	ELP	El Paso	Small	1,931,067
70	OKC	Oklahoma City	Small	1,928,418
71	SRQ	Sarasota	Small	1,911,999
72	GEG	Spokane	Small	1,905,541





# Eppley Airfield Total Passengers

1986-2023

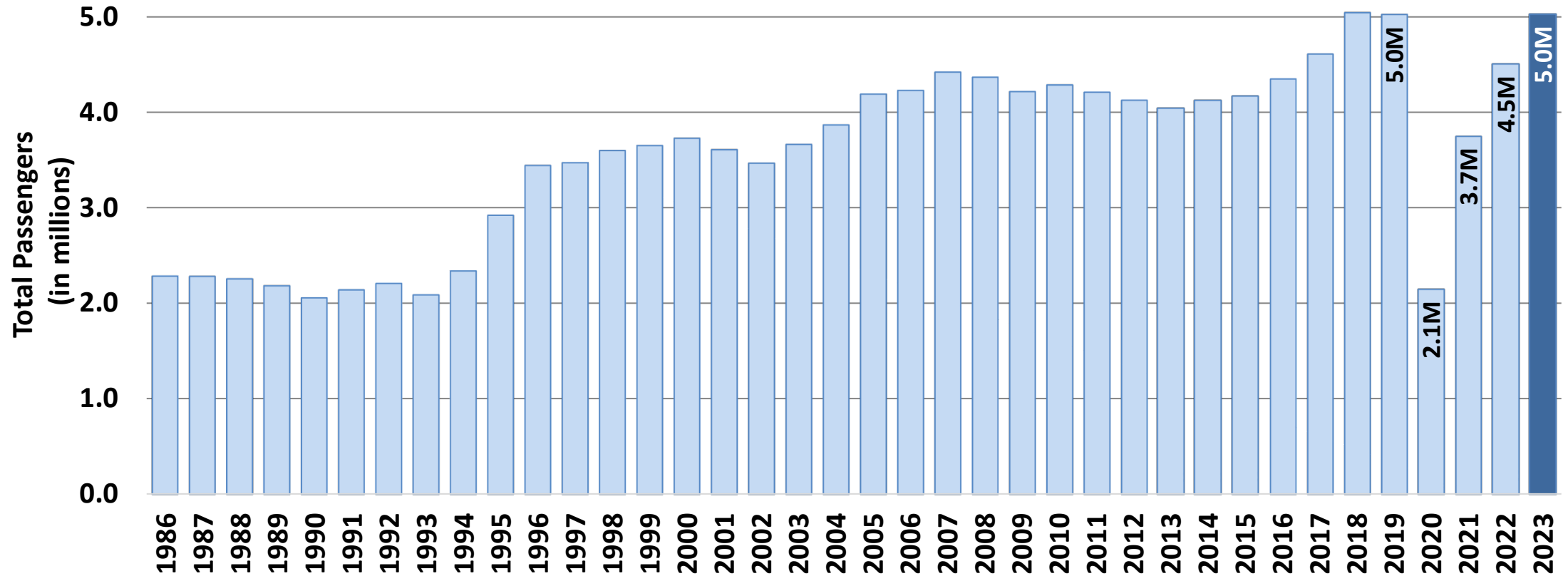

# Airline Route Map – January 2024



# Program Goals and Objectives

- Establish a **need-based** development plan based on activity at the Airport and level of service trigger points;
- Maintain **customer convenience** and improve the **customer experience**; and
- Provide a **cost-effective, phased implementation** plan.

# 2013 Terminal Area Master Plan

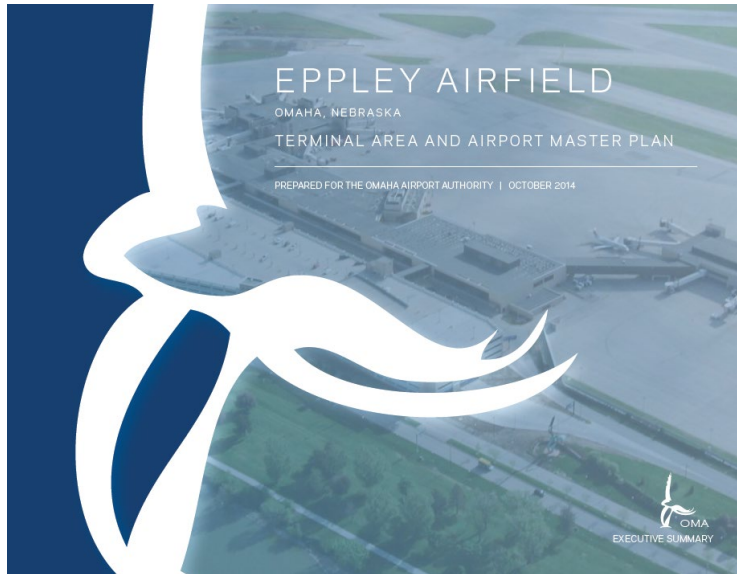

The four PALs defined in the Master Plan

- Baseline: 4,300,000 passengers
- PAL 1: 4,800,000 passengers
- PAL 2: 5,400,000 passengers
- PAL 3: 7,000,000 passengers



INITIAL TERMINAL ALTERNATIVES

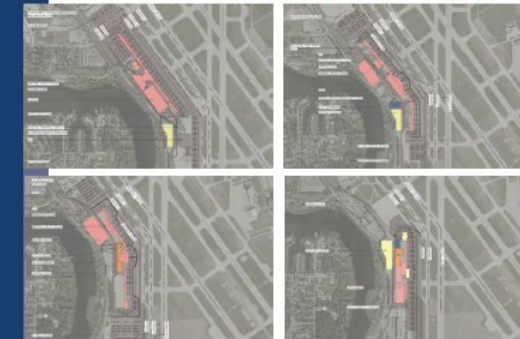

SHORTLISTED TERMINAL ALTERNATIVES



PREFERRED ALTERNATIVE

EPPLEY AIRFIELD HISTORIC & FORECAST PASSENGER ACTIVITY

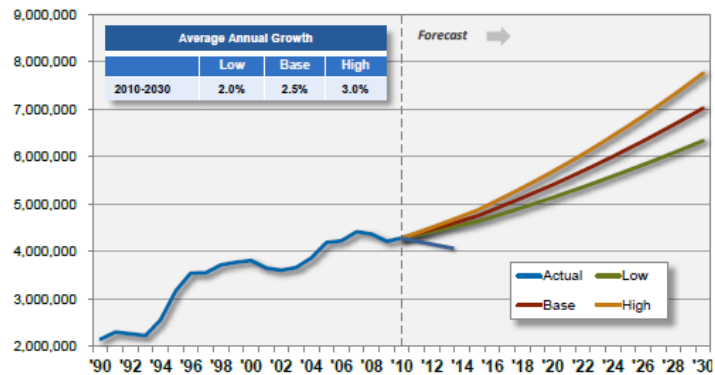

FORECASTED TOTAL PASSENGERS & PASSENGER ACTIVITY LEVELS

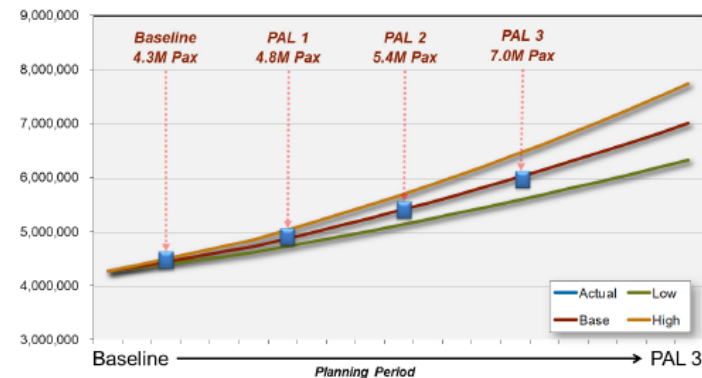

# Forecast of Aviation Demand

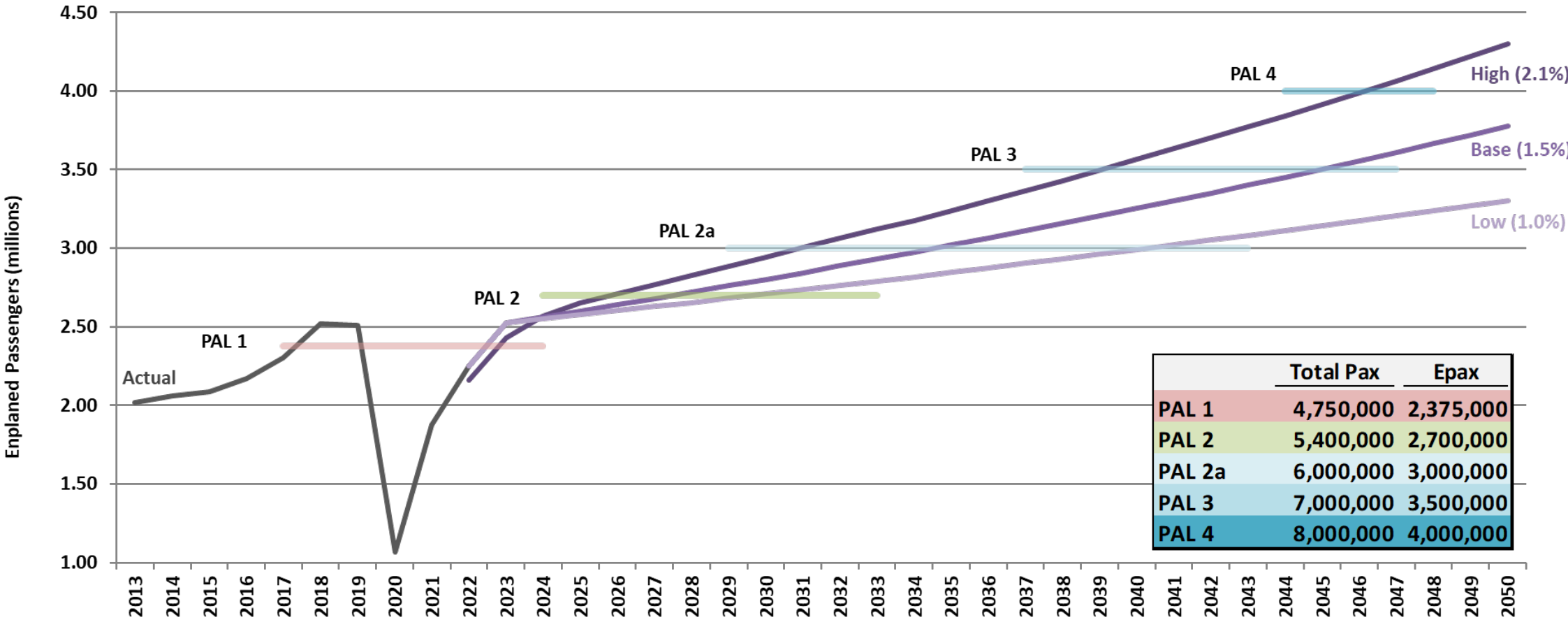

Low Forecast: LeighFisher projection for 2023 of 2.525 million enplaned passengers prepared in June 2023. Assumes average annual growth of 1.0% between 2023 and 2050.  
 Base Forecast: LeighFisher projection for 2023 of 2.525 million enplaned passengers prepared in June 2023. Assumes average annual growth of 1.5% between 2023 and 2050.  
 High Forecast: Enplanements per the FAA's 2023 *Terminal Area Forecast* (TAF) issued in February 2023. Average annual growth of 2.1% from 2023 to 2050.

Sources:  
 Omaha Airport Authority; LeighFisher; FAA

# New North Garage and Rental Car Facility

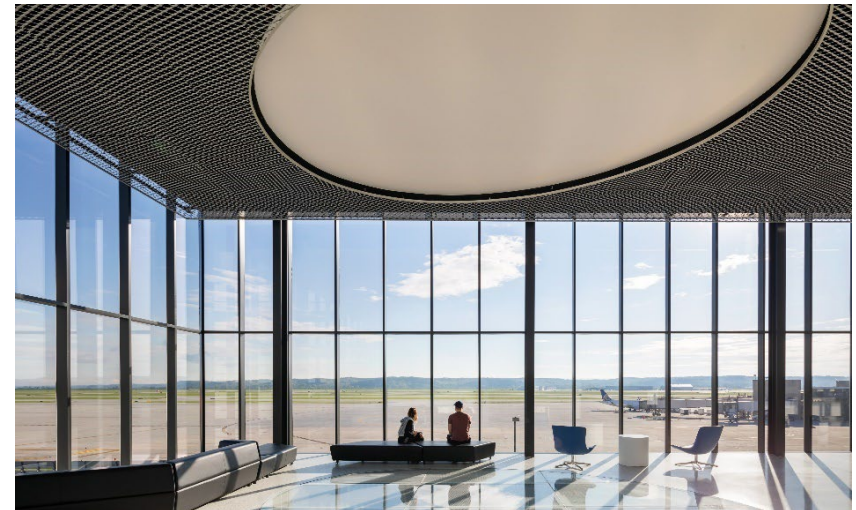
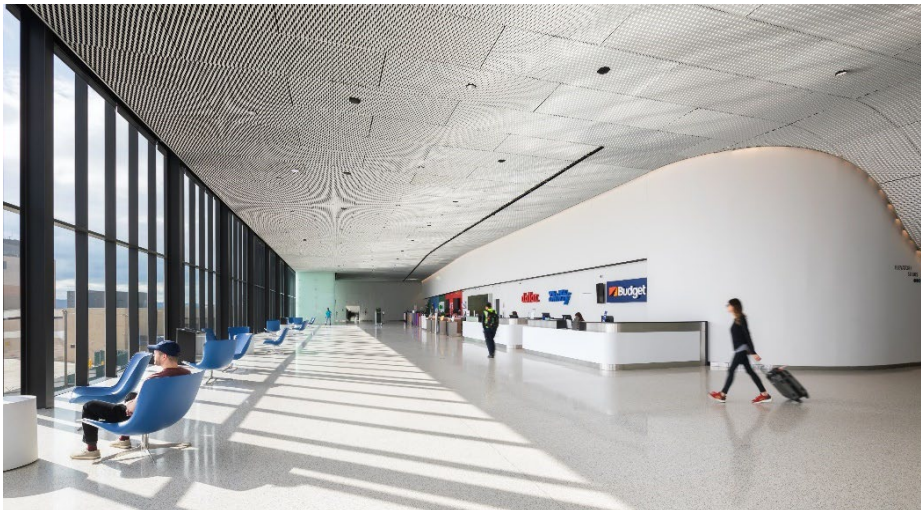

# Terminal Entrance Roadway Expansion





# Terminal Drive & Canopy Project



# Terminal Modernization Program Update

# TMP Overview



-  Central Utility Plant and Loading Dock
-  Terminal Expansion and Renovation

# Design Detail By the Numbers

- **Airport Terminal**

- Before: 375,484 SF
- After: 646,000 SF

- **Post Security Concessions**

- Before: 7,365 SF
- After: 27,660 SF

- **Gate Waiting Areas**

- Before: 1,800 SF/Gate
- After: 2,600 SF/Gate

- **Baggage Claim**

- Before: 12,350 SF
- After: 34,400 SF

# Terminal Modernization Program Upper and Lower-Level Floor Plan

Upper Level



Lower Level



\*90% design



# Terminal Modernization Program Curbside View of Central Pavilion



# Terminal Modernization Program Airline Ticketing



# Terminal Modernization Program Central Pavilion Entry



# Terminal Modernization Program Central Pavilion Security Checkpoint





# Terminal Modernization Program Central Pavilion Post-Security and Concessions



# Terminal Modernization Program Typical Gate Holdroom



# Terminal Modernization Program Baggage Claim



# Terminal Modernization Program Site Overview

# Stakeholder Engagement



# Design-Build Team



- Local members of the Design/Management Team
- 75% of Construction Subcontractors are local
- SEB/DBE Program

# TMP Funding Sources

TMP Budget: \$950m

## PROJECT FUNDING – USER FEE AIRPORT

Airport Revenues

Airport Bonds

Passenger Facility Charge

TSA

FAA / BIL

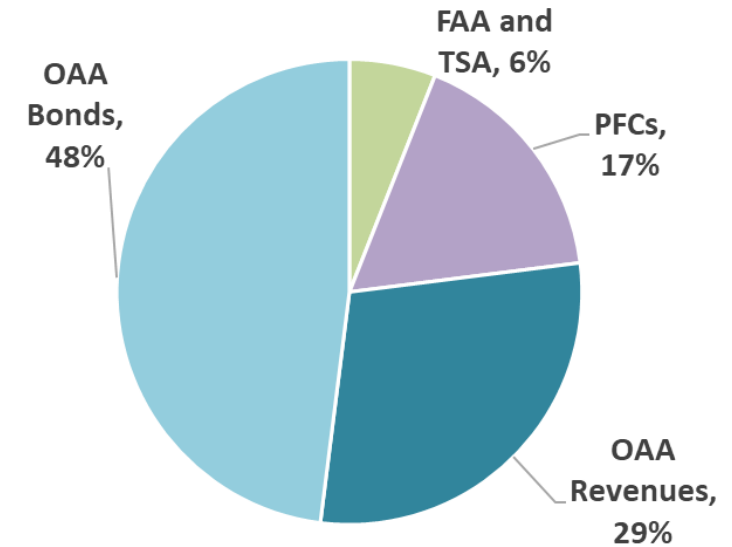

# TMP Schedule Overview

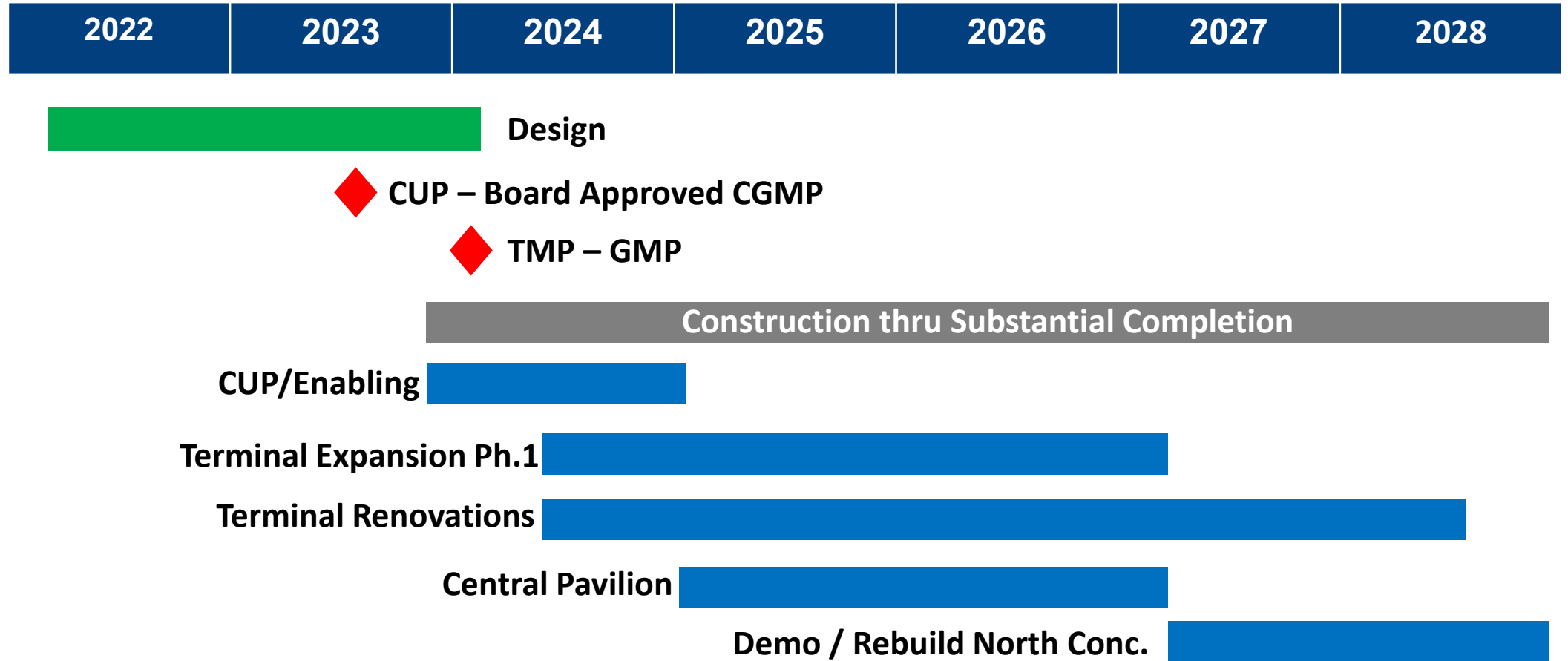





# Questions & Comments

# Thank You

**BUILD** **OMA** **TERMINAL  
MODERNIZATION  
PROGRAM**

# Banquet Close

- PDHs Certificates are available and on our Omaha Post Website
  - ▶ <https://www.same.org/omaha/resources/>