



# SPACE RAPID CAPABILITIES OFFICE (SpRCO) HEADQUARTERS

KIRTLAND AIR FORCE BASE, NEW MEXICO

CUSTOMER: USSF SPACE RAPID CAPABILITIES OFFICE

In 2018, with changes in 2019, Congress established the Space Rapid Capabilities Office (SpRCO) as a program office within Air Force Space Command. The mission of SpRCO is to contribute to the development of low cost, rapid reaction payloads, busses, launch, and launch control capabilities in order to fulfill joint military operational requirements for on-demand space support and reconstitution. The mission enables the ability to expedite the fielding of critical space capabilities to the warfighter and to enhance the materiel responses to Combatant Commander needs. Due to the sensitivity and increased growth of the number of SpRCO personnel, the current facility space significantly limits the ability to perform mission requirements.

The new facility will be designed to house secure administration space necessary for the operation of approximately 300 military, civilian, and contractor personnel. In addition, the facility will require secure accreditation, with necessary physical and electronic security measures. The project will also include a 200-seat auditorium. The SpRCO building program requires separate administrative areas for fifteen (15) departments, with meeting spaces of various sizes from small huddle rooms for 2 – 4 people to a large 50-person conference room. The design team developed multiple site and building configuration concepts to assist in the validation of the space needs and adjacency requirements between the different departments. In collaboration with the stakeholders, the preferred option was selected for further development into a conceptual design.



CONCEPT SKETCH

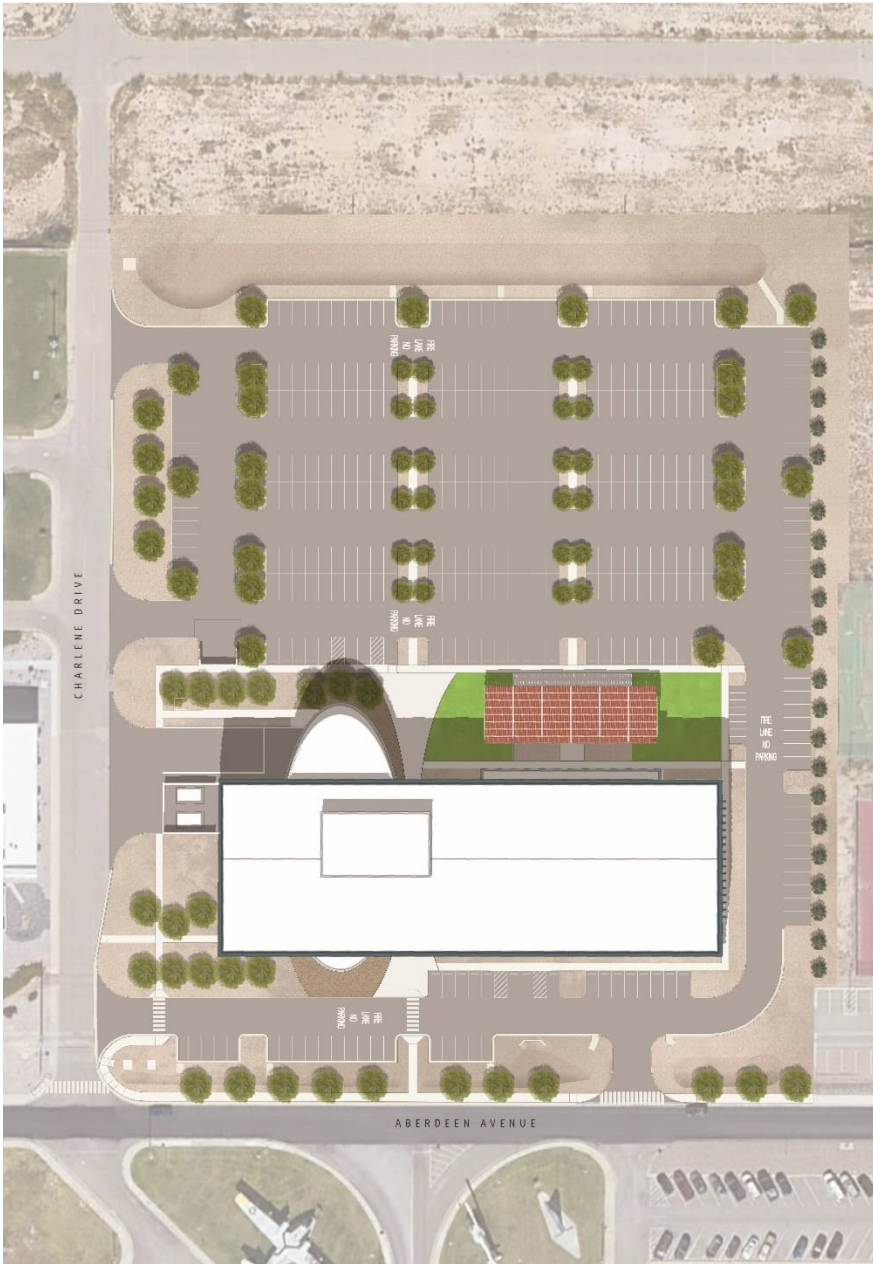

SITE PLAN



SECOND FLOOR PLAN

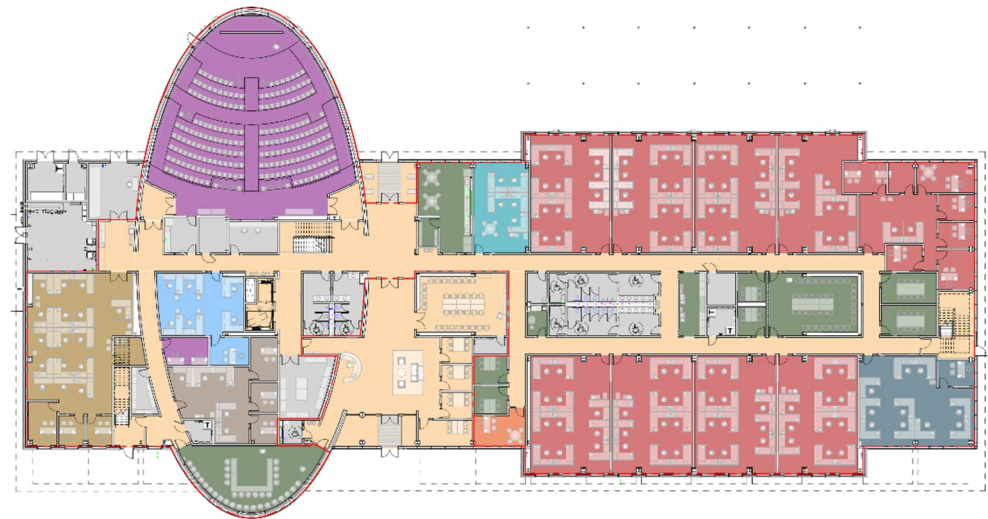

FIRST FLOOR PLAN

Sited parallel to and on the North side of Aberdeen Street, east of Charlene Avenue, the new SpRCO Headquarters Facility will be located adjacent to the existing West Side Fitness Center. The orientation of the building allows for visibility of the main entrance from the main thoroughfare of Aberdeen Street. The long axis of the building faces east/west to take advantage of natural daylighting on the north and south sides of the building. The visitor parking lot on the south side of the building aligns with, but does not connect to, the existing parking lot for the adjacent recreation center for separate of traffic. Staff parking will be located to the north of the building for ease of access to the secure entrance.

The building mass consists of a long, upper-volume rectangular form intersected by a smaller rectangle on the East side and a large ellipse on the West side. This ellipse accents the main entrance that is centered on the street (Doris Avenue) that lies perpendicular to the project site. The large overhang on the South side of the facility provides shading to the building façade and gives the building a bold appearance along Aberdeen Street. The upper-volume form is clad in a “steel blue” metal panels forming a complete frame of the second floor on both the South and North sides of the building.

#### EXTERIOR VIEWS





The square form on the east side of the building will be comprised of vertical precast concrete panels and with full-height vertical clear anodized aluminum window framing. The verticality of the square form serves as a balanced contrast to the horizontality of the upper rectangular form. To reinforce the horizontality, only horizontal window mullions will be visible on the exterior of the building. All vertical mullions are interior to the building with butt-glazed exterior joints. On the west side, the elliptical form intersects through the rectangular form on the South side of the building as a large conference room and as the Auditorium on the North side of the building. The elliptical form reflects the function of these spaces and focuses the audience towards the presentation side of the spaces. This form will be clad in "beige" horizontal metal panels in a running bond on the exterior of the building, providing a human scale to these building elements.



SpRCO HQ

MAIN ENTRANCE

In order to create a cohesive aesthetic for the building between the exterior massing and the interiors of the building, a Mid-Century Modern design concept will be implemented at the common use and assembly spaces within the new facility. The general color palette for the interior finishes and furniture are aligned with this concept, and additional design features will carry through the building as ways to form the spaces. Wood slat ceilings and walls, round ceiling and floor elements, pipe details and casework forms will complete the design concept. Within the Lobby space, the exterior ellipse continues into the interior of the building, maintaining the same pattern and linear light accents, sculpting the volume and defining the West side circulation on both floor levels of the facility.



LOBBY



CENTRAL STAIR

The first and second floor areas will be split between West and East side administrative areas, due to the central location of the main entrance/lobby area. Circulation between floors is provided through two elevators, two fire exits, and one convenience stair. The central stair is open to the adjacent circulation space and secure lobby area, with terrazzo flooring, wood slat ceilings and walls and pipe detailing with floating treads, all enhancing the interior design aesthetic. The circular light fixtures around the central stair align with similar components in the terrazzo flooring below. This design execution is aligned with the colored ceiling elements and terrazzo flooring features within the main Lobby space.



MEETING ROOM

All of the meeting rooms in the new facility will have a similar concept with wood slat ceilings that fold down the presentation wall and linear pendant lights leading the occupant eye to the front of the room. The wood slat system used throughout the building, along with carpet tile in meeting rooms specifically, will provide sound absorption within the space to optimize the acoustical performance and occupant comfort in each of the spaces.

Building personnel will be able to enter the facility from either the North or through the Southern lobby with badge access. All visitors and personnel without clearance will enter through the South into the unsecure Lobby space. Within the Lobby, the security desk provides a location for visitors to register and for uncleared personnel to check-in and meet with building personnel. On the North side of the Lobby, card readers provide access into the secure area. The core of the building includes all restrooms, meeting rooms and other building support spaces. This arrangement will allow for maximized the access to natural light for all of the administrative functions.

Assembly areas on the West side include the 200-seat Auditorium, with a Kitchenette, Control Booth, and Platform on the north side of the building and a large 50-person Conference Room. The Auditorium space is located within the elliptical form on the north side of the building, formed for optimal acoustical performance. The material selections align with the Mid-Century Modern interior concept, with wood slat walls, pipe detailing and circular “clouds” above, sized and placed at differing elevations to enhance the acoustical quality of the space. The platform in the space includes area for speaker(s) and a video monitor wall for optimum viewing by all occupants.

## INTERIOR VIEWS





# SPACE RAPID CAPABILITIES OFFICE (SpRCO) HEADQUARTERS

KIRTLAND AIR FORCE BASE, NEW MEXICO

ANTICIPATED COMPLETION OF CONSTRUCTION 2029